

APROVADA: 01/07/63
PROTOCOLADO: 25/01/63 - N° 0793
ESCALA: 1/1000

PROTOCOLADO: 25/01/63 - N° 0793

ESCALA: 1/1000

COOPERATIVA HAB. DOS EMPREGADOS EM ESTABELICIMENTO BANCÁRIOS DE CAMPO GRANDE LTDA

PROTOCOLADO: 04/10/73 - N° 49.267/73

ESCALA: 1/1000

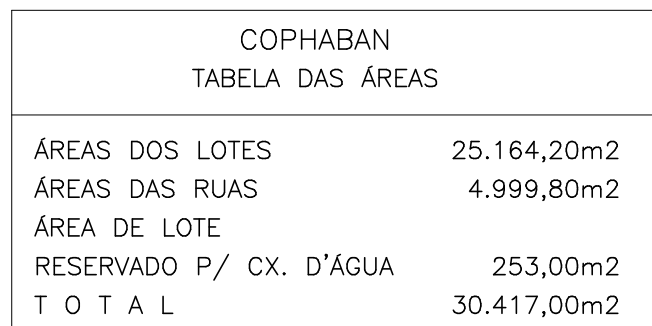

L E G E N D A					
R/D	QUADRA	LOTE(S)	LOTE(S)ATUAL	PROCESSO	PROPRIETÁRIO
R	01	5e6	5A	36.477/93	MARIA LACERDA DE LIMA
R/D	03	9,10e11	9A,10A	42.354/92	SIDNEI VALIERI
R	03	10A,12e14	12A	54.384/94	SIDNEI VALIERI

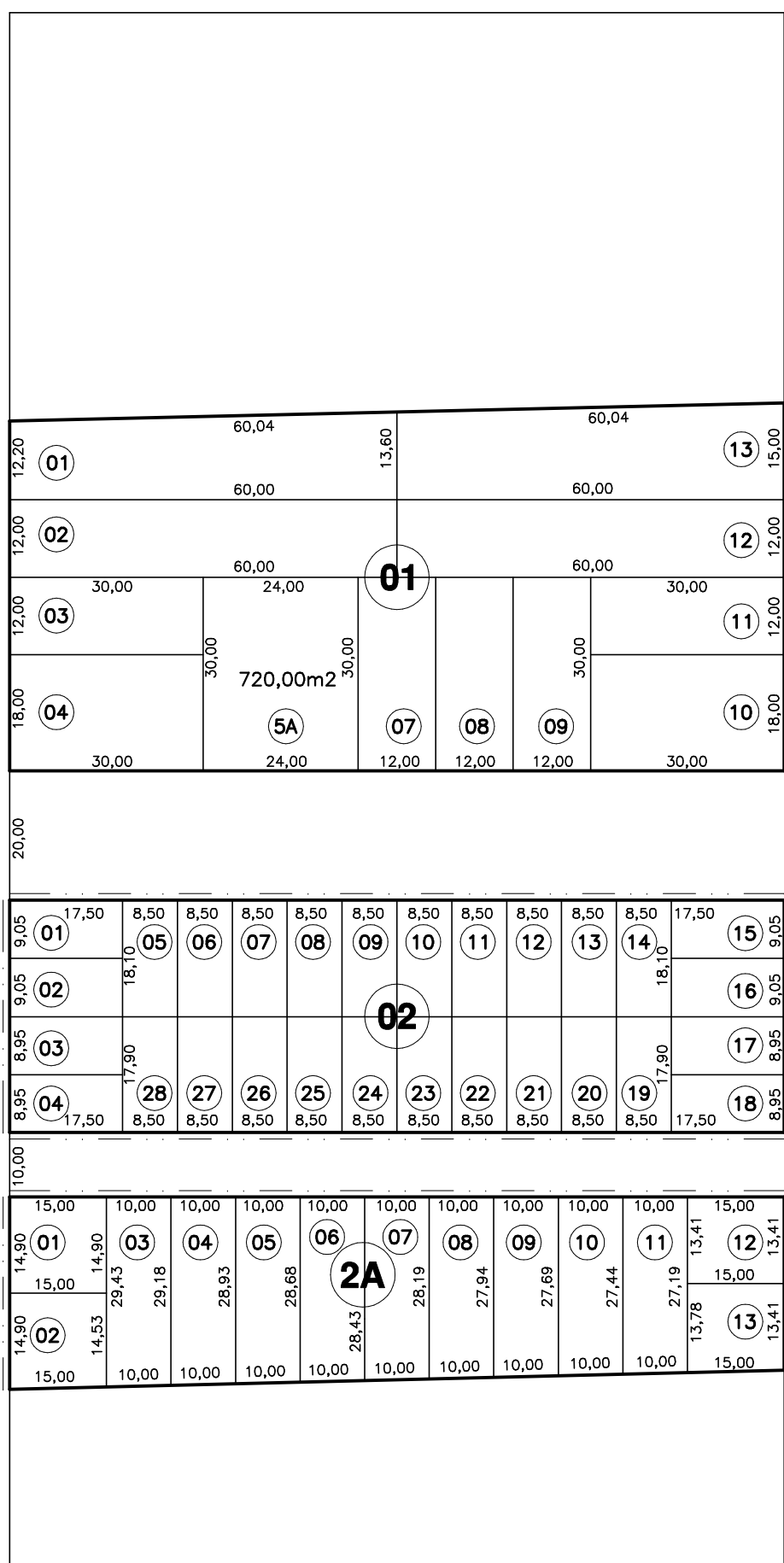

RUA GOIÁS

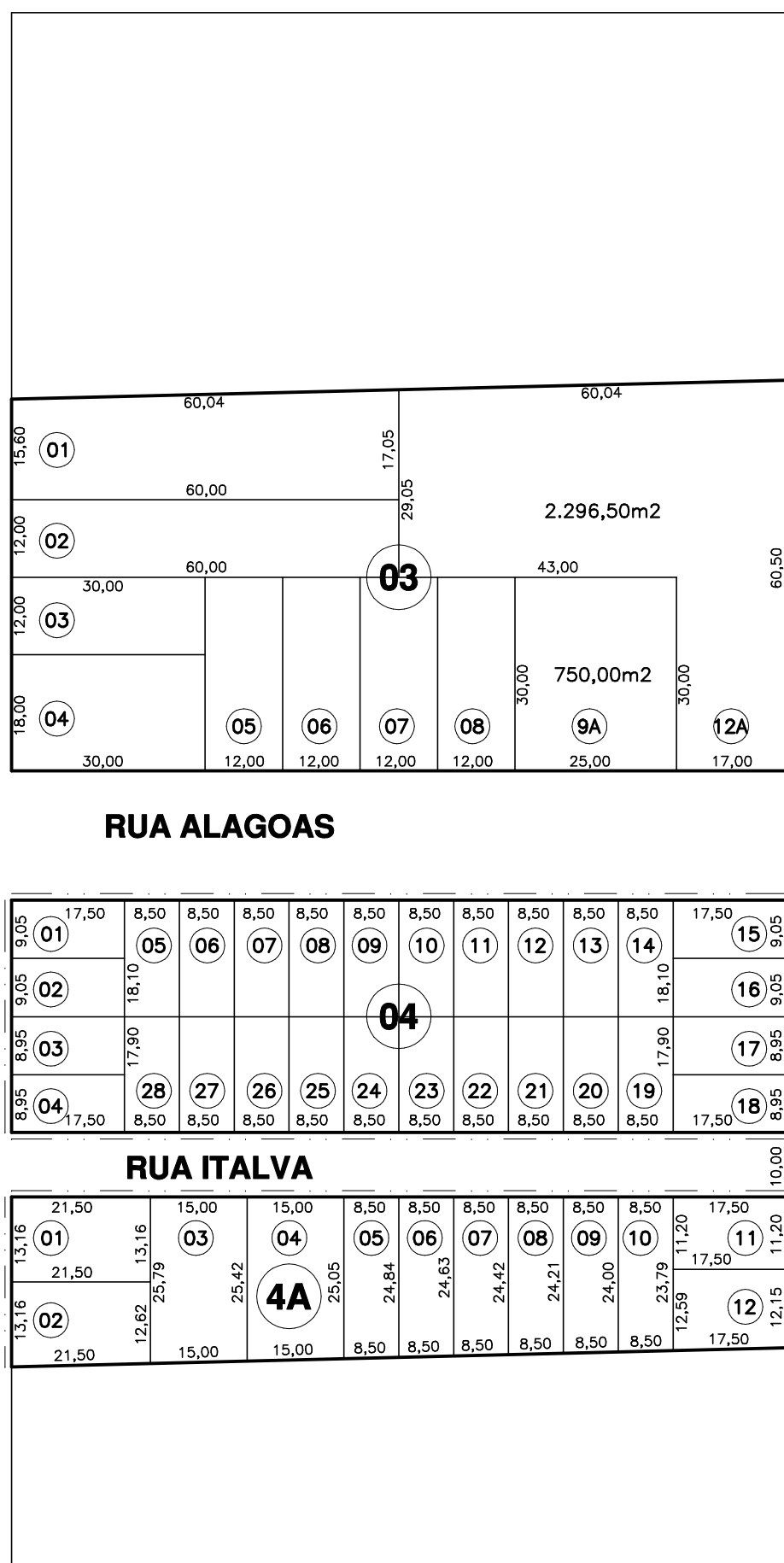

RUA DAS GARÇAS

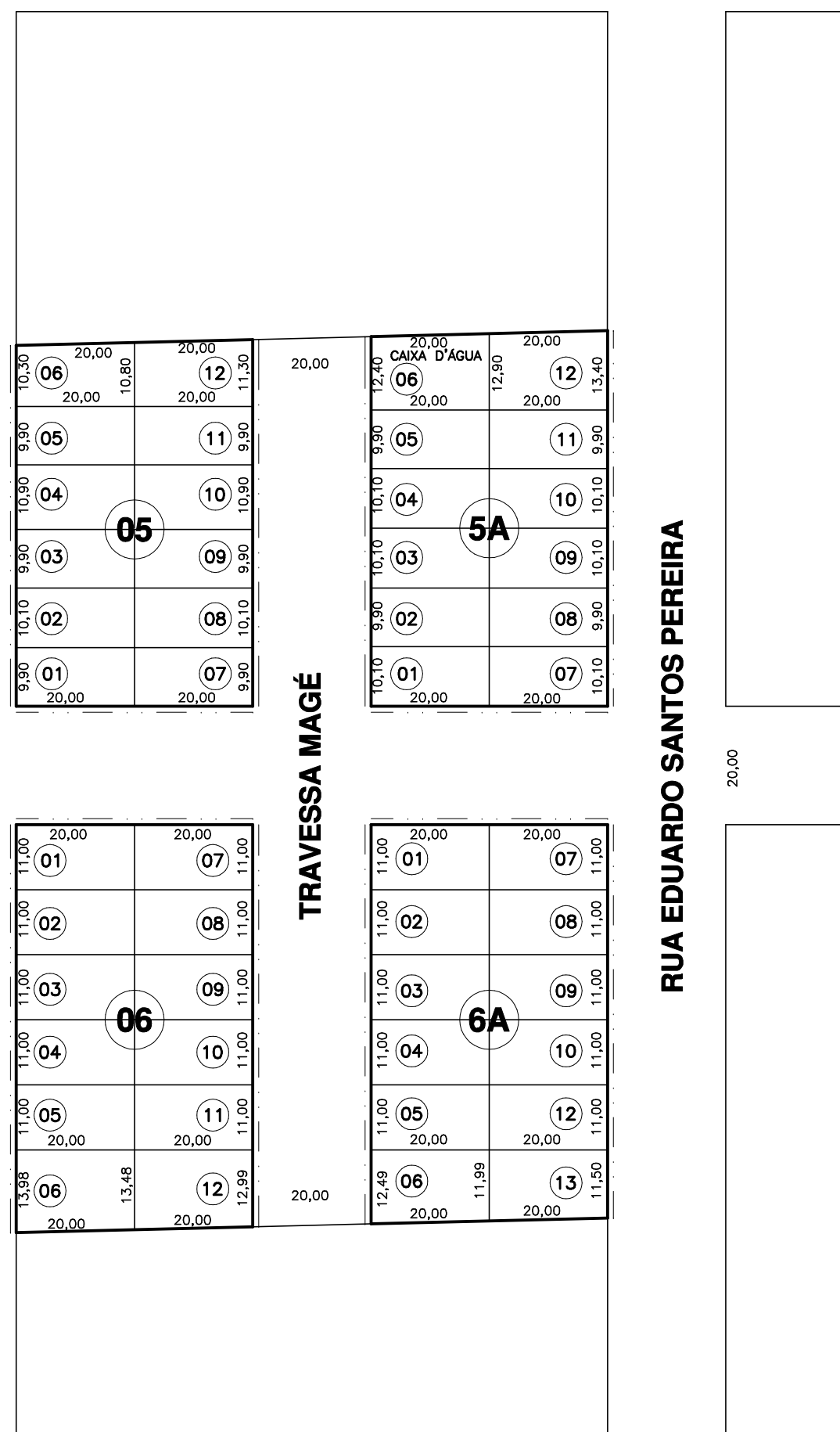

RUA EDUARDO SANTOS PEREIRA