

JARDIM ITÁLIA

BAIRRO: POPULAR (CONFORME LEI 74/2005)

ÁREA 10-A, NOVA CAMPO GRANDE
PROPRIETARIO: FINANCIAL IMOBILIARIO S.A.
RESP. TECNICO – WALDO SILVA PIMENTEL – ENG. CIVIL, CREA 1209/D – MS
APROVADO EM 09/04/90
PROCESSO N: 62.825/89
ESCALA: 1/2000

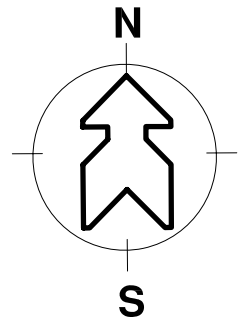

PERFIL DE RUAS

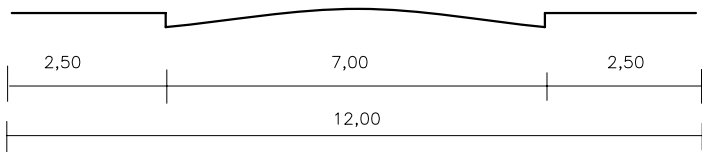
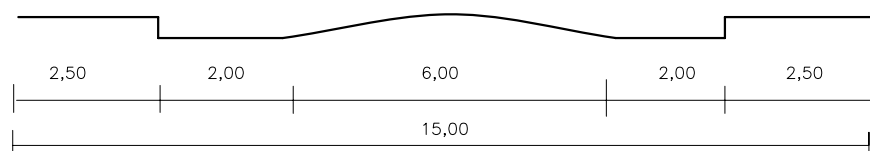
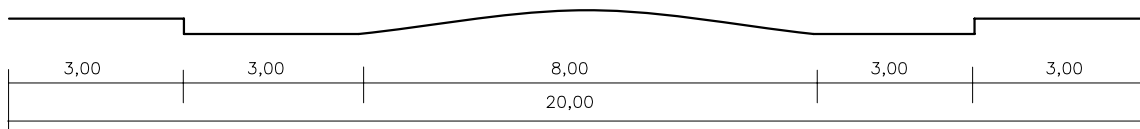

SECÇÃO DE RUAS
ESC: 1/200

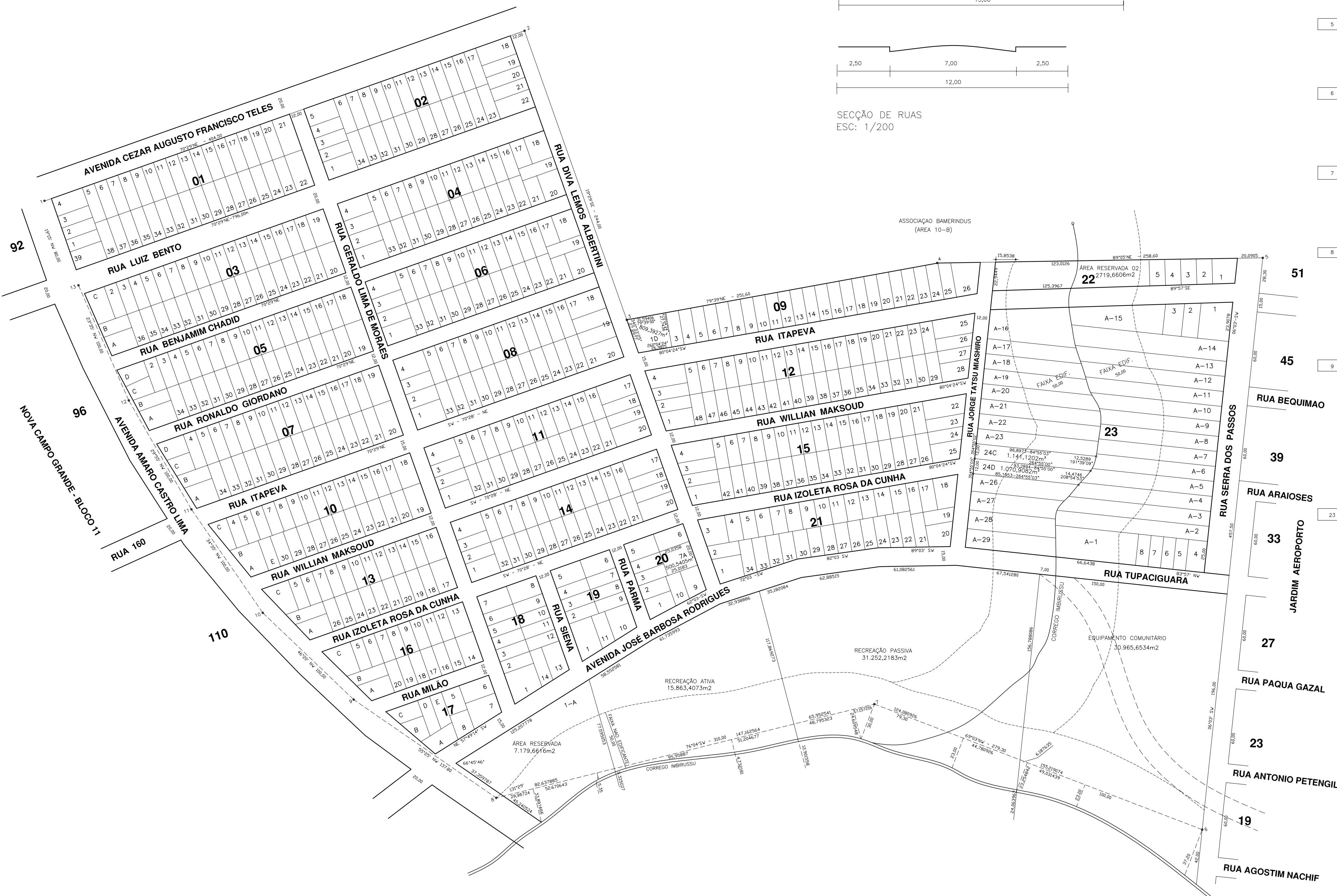

LEGENDA DE LOTES

QUADRA	LOTE	FRENTE	FUNDO	DESBERTO	ESQUERDO	ÁREA (m2)	
1	1	10,00	10,00	26,2649	26,3144	262,8965	
	2	10,00	10,00	26,2155	26,2849	262,4020	
	3	10,00	10,00	26,1661	26,2155	261,9080	
	4	15,00	15,00	26,0919	26,1661	391,3500	
2	5a20,23a38	10,00	10,00	30,00	30,00	300,00	
	21	22	15,00	15,00	26,3144	26,3886	395,2725
	1e5	22	15,00	15,00	30,00	30,00	450,00
	2 a 4	10,00	10,00	25,00	25,00	250,00	
3	6a17e23a34	10,00	10,00	30,00	30,00	300,00	
	18	15,00	15,00	29,3950	29,4081	411,6233	
	19	10,00	10,00	29,3863	29,3950	293,9065	
	20	10,00	10,00	29,3775	29,3863	293,8190	
4	21	10,00	10,00	29,3688	29,3775	293,7315	
	22	15,00	15,00	29,3557	29,3688	404,4338	
	A	16,0831	16,00	24,1376	22,5045	373,3736	
	B	11,0571	11,00	25,2603	24,1376	271,6885	
5	C	16,4875	15,2803	27,00	27,0279	428,6563	
	2a18a21a34	10,00	10,00	27,00	27,00	270,00	
	18a20	15,00	15,00	27,00	27,00	405,00	
	1e4	15,00	15,00	25,00	25,00	375,00	
6	2e3	12,00	12,00	25,00	25,00	300,00	
	17a21	12,00	12,00	22,00	22,00	264,00	
	18	17,2807	17,2615	22,00	22,00	379,9642	
	19	10,00	10,00	29,2527	29,2615	292,2710	
7	20	17,2335	17,2527	22,00	22,00	379,3482	
	5a6e22a33	10,00	10,00	27,00	27,00	270,00	
	A	19,0194	18,4939	23,9679	19,5279	402,2035	
	B	11,3126	11,00	26,6087	23,9679	278,1713	
8	C	17,7707	14,4938	19,4551	16,6087	261,2508	
	D	15,2865	15,00	22,4009	19,4551	313,582	
	4a18	10,00	10,00	29,4938	29,4938	294,9390	
	20	15,00	15,00	29,4938	29,4938	442,4070	
9	21a34	10,00	10,00	29,4939	29,4939	442,4085	
	1	17,4939	17,4939	25,00	24,9939	437,3475	
	2 e 3	12,00	12,00	25,00	25,00	300,00	
	4	17,4938	17,4938	25,00	25,00	437,3450	
10	5a16	10,00	10,00	29,4938	29,4938	294,9380	
	17	12,00	12,00	24,4938	24,4938	293,9256	
	18	17,2231	17,2017	24,4938	24,4938	421,5971	
	19	10,00	10,00	29,1930	29,2017	291,9735	
11	20	17,1716	17,1930	24,4939	24,4939	420,8615	
	21	12,00	12,00	24,4939	24,4939	293,9258	
	22a3	10,00	10,00	24,4939	294,9390		
	2 e 3	16,9815	21,50379	27,8977	27,6697	532,3262	
12	3	10,00	10,00027	27,6697	27,7436	277,0665	
	2	10,00	10,00027	27,7436	27,8175	277,8055	
	5	10,00	10,00027	27,8175	27,8914	278,5445	
	4	10,00	10,00027	27,8914	27,9653	279,2835	
13	6	10,00	10,00027	27,9653	28,0392	280,0025	
	7	10,00	10,00027	28,0392	28,1131	280,7615	
	8	10,00	10,00027	28,1131	28,1870	281,5005	
	9	10,00	10,00027	28,1870	28,2609	282,2395	
14	10	10,00	10,00027	28,2609	28,3348	282,9785	
	11	10,00	10,00027	28,3348	28,4087	283,7175	
	12	10,00	10,00027	28,4087	28,4826	284,4565	
	13	10,00	10,00027	28,4826	28,5565	285,1955	
15	A-1	10,00	10,00027	28,5565	28,6304	285,9345	
	A-2	12,00	10,00/2,4124	121,6438	121,6438	1459,7528	
	A-3	12,00	14,4746	121,6438	113,5497	1411,1610	
	A-4	12,00	14,4746	113,5497	105,4556	1314,0318	
16	A-5	12,00	14,4746	105,4556	97,3615	1216,0582	
	A-6	12,00	4,1636/8,5532	97,3615	95,0338	1146,2400	
	A-7	12,00	12,0073	95,0328	94,1318	1137,9396	
	A-8	12,00	9,4395/2,8050	94,1318	94,2860	1126,1224	
17	A-9	12,00	13,1515/4,49	94,2860	99,6287	1163,6492	
	A-10	12,00	13,3356	99,6279	104,9715	1227,6212	
	A-11	12,00	13,3356	104,9715	110,3142	1291,7142	
	A-12	12,00	13,3356	110,3142	115,6569	1355,8266	
18	A-13	12,00	13,3356	115,6569	120,9996	1419,9390	
	A-14	16,00	11,515/5,49	120,9996	125,6802	1986,2860	
	A-15	17,7178	12,6802	18,5473	11,37	1044,2930	