

JARDIM AMETISTA

PROPRIETÁRIO: ARI GIACHINI
APROVADO: 25/02/1981
PROCESSO: 09077/80
ESCALA: 1:1000

LOCAL: LOTE 4C – DESMEMBRADO DO LOTE 4
PARTE DAS FAZENDAS BÁLSAMO E COLONIAL

RESUMO DAS ÁREAS

QUADRAS	72.880,39m2
RUAS	39.119,79m2
ÁREAS VERDES	13.138,057m2
TOTAL	125.138,230m2

PERFIL TRANSVERSAL DAS RUAS
ESCALA 1/250

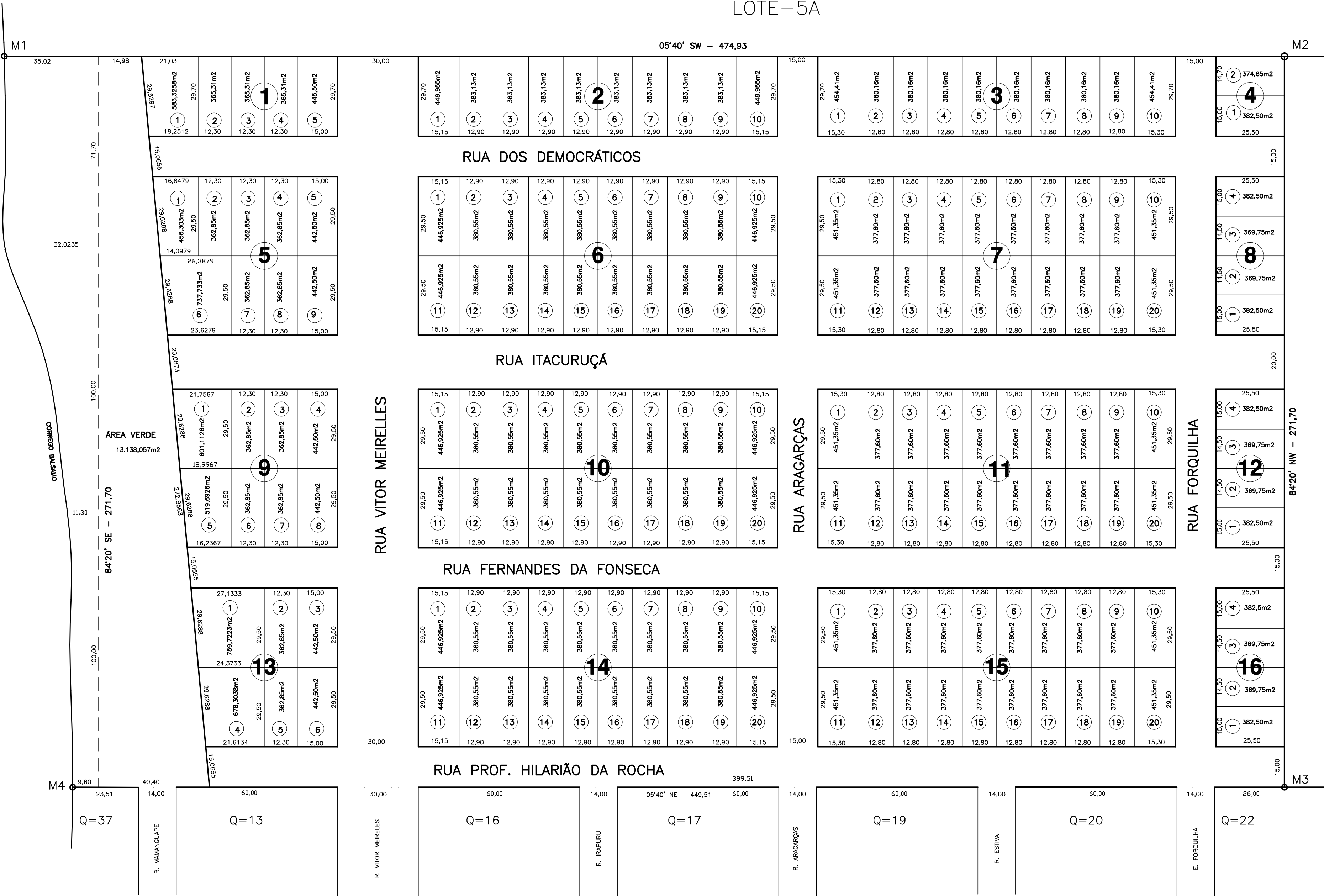
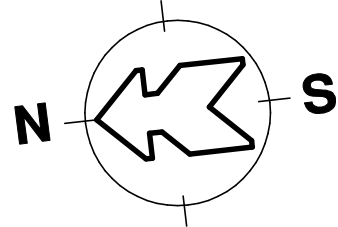
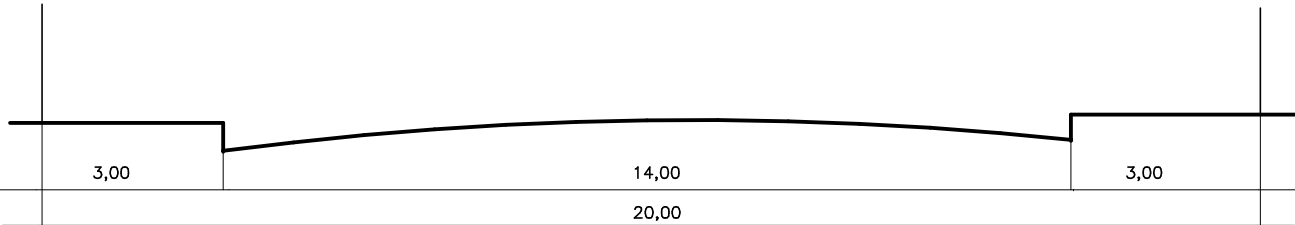
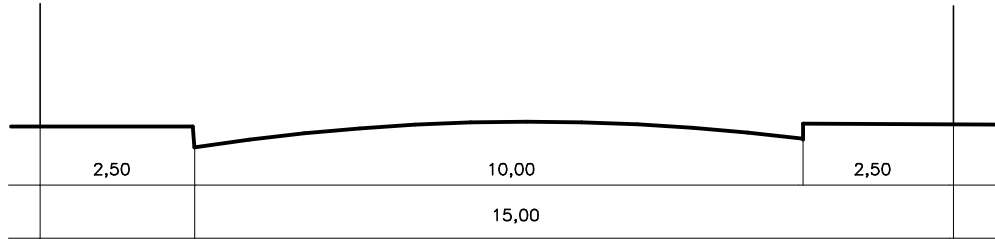

ATACADÃO S/A, COM., IMPORTAÇÃO E EXPORTAÇÃO
LOTE—4B